

Каталог самоходных штабелеров BT Staxio



email: info@forstor.com.ua

site: www.forstor.com.ua

TOYOTA

MATERIAL HANDLING

stronger together

Pedestrian stacker truck 0.8 ton

BT staxio
SWE080L



 **FORSTOR**

email: info@forstor.com.ua

site: www.forstor.com.ua

TOYOTA

MATERIAL HANDLING

stronger together

Pedestrian stacker with elevating support arms

| Specification for stacker trucks | | | | | SWE080L | |
|----------------------------------|------------------|---|---|-----|--------------------------------------|-------------------|
| Identification | 1.1 | Manufacturer | | | BT | |
| | 1.2 | Model | | | SWE080L | |
| | 1.3 | Drive | | | Electric | |
| | 1.4 | Operator type | | | Pedestrian | |
| | 1.5 | Load capacity/rated load | Q | kg | 800 | |
| | | Support arm capacity/fork and support arm capacity | Q | kg | 2000/— | |
| | 1.6 | Load centre | c | mm | 600 | |
| | 1.8 | Load distance, centre of support arm wheel to face of forks | x | mm | 815 | |
| | 1.9 | Wheelbase | y | mm | 1293 | |
| Weight | 2.1 | Service weight including battery | | kg | 679 | |
| | 2.2 | Axle load, with load, drive/castor/fork wheel | | kg | 525/150/830 | |
| | 2.3 | Axle load, without load, drive/castor/fork wheel | | kg | 375/150/180 | |
| Wheels | 3.1 | Drive/castor/fork wheel | | | Powerfriction/Vulkollan/Vulkollan *) | |
| | 3.2 | Wheel size, front | | mm | Ø230x70 | |
| | 3.3 | Wheel size, rear | | mm | Ø85x74 | |
| | 3.4 | Additional wheels (dimensions) | | mm | Ø125x50 | |
| | 3.5 | Wheels, number front/rear (x=driven wheels) | | | 1x+2/4 | |
| | 3.6 | Track width, front | b ₁₀ | mm | 430 | |
| | 3.7 | Track width, rear | b ₁₁ | mm | 390 | |
| Dimensions | 4.2 | Height, mast lowered | h ₁ | mm | 1863 *) | |
| | 4.3 | Free lift | h ₂ | mm | 1580 *) | |
| | 4.4 | Lift | h ₃ | mm | 1490 *) | |
| | | Lift height | h ₂₃ | mm | 1580 *) | |
| | 4.5 | Height, mast extended | h ₄ | mm | 1863 *) | |
| | 4.6 | Initial lift | h ₅ | mm | 120 | |
| | 4.9 | Height of tiller in drive position, min./max. | h ₁₄ | mm | 865/1235 | |
| | 4.15 | Height, fork lowered | h ₁₃ | mm | 90 | |
| | 4.19 | Overall length | l ₁ | mm | 1777 | |
| | 4.20 | Length to face of forks | l ₂ | mm | 627 | |
| | 4.21 | Overall width | b ₁ | mm | 726 | |
| | 4.22 | Fork dimensions | s/e/l | mm | 60/180/1150 *) | |
| | 4.24 | Fork-carriage width | b ₃ | mm | 674 | |
| | 4.25 | Width over forks | b ₅ | mm | 570 *) | |
| | Performance data | 5.1 | Travel speed, with/without load | | km/h | 6/6 |
| 5.2 | | Lift speed, with/without load | | m/s | 0.14/0.21 | |
| 5.3 | | Lowering speed, with/without load | | m/s | 0.29/0.20 | |
| 5.8 | | Max. gradeability, with/without load | | % | 9/18 ¹⁾ | |
| 5.10 | | Service brake | | | Electromagnetic | |
| Electric motor | | 6.1 | Drive motor rating S2 60 min | | kW | 1.0 |
| | | 6.2 | Lift motor rating at S3 15% | | kW | 2.0 ²⁾ |
| | | 6.4 | Battery voltage/nominal capacity K _s | | V/Ah | 2x12/180 *) |
| | 6.5 | Battery weight | | kg | 2x92 *) | |
| | 8.1 | Type of drive control | | | BT Powerdrive | |

¹⁾ Measured according to company standard

²⁾ S3 7%

*) Further alternatives are available and will produce other values.

Data is based on standard configurations: h₂₃ = 1580 mm Mono mast.

Truck performance and dimensions are nominal and subject to tolerances.
BT Products AB products and specifications are subject to change without notice.

Mast dimensions

BT staxio

| SWE080L | | | Mono | |
|----------|-----------------------------------|----|------|------|
| h_{23} | Lift height ($h_{13}+h_3$) | mm | 600 | 1580 |
| h_3 | Lift | mm | 510 | 1490 |
| h_1 | Height, mast lowered | mm | 908 | 1863 |
| h_2 | Free lift, ground to top of forks | mm | 600 | 1580 |
| h_4 | Height, mast extended | mm | 908 | 1863 |

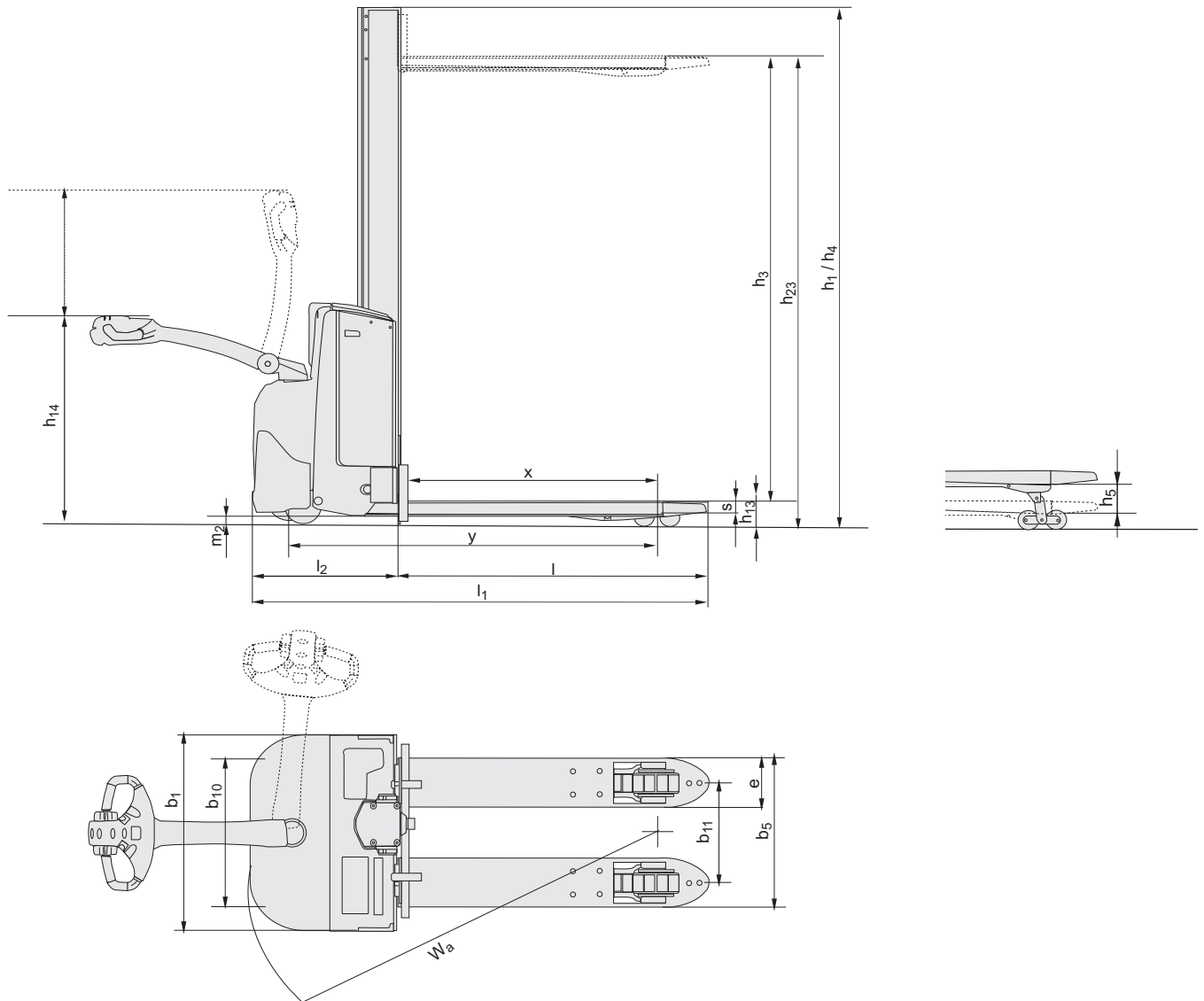

BT Staxio

SWE100



email: info@forstor.com.ua

site: www.forstor.com.ua



Pedestrian Stacker

BT Staxio

| Specification for stacker trucks | | | | | SWE100 | |
|----------------------------------|------------------|---|---|-----------------------|--------------------------------------|-------------------|
| Identification | 1.1 | Manufacturer | | | BT | |
| | 1.2 | Model | | | SWE100 | |
| | 1.3 | Drive | | | Electric | |
| | 1.4 | Operator type | | | Pedestrian | |
| | 1.5 | Load capacity/rated load | Q | kg | 1000 | |
| | 1.6 | Load centre | c | mm | 600 | |
| | 1.8 | Load distance, centre of support arm wheel to face of forks | x | mm | 663 | |
| | 1.9 | Wheelbase | y | mm | 1195 | |
| | Weight | 2.1 | Service weight including battery | | kg | 808 |
| 2.2 | | Axle load, with load, drive/castor/support arm wheel | | kg | 350/280/1185 | |
| 2.3 | | Axle load, without load, drive/castor/support arm wheel | | kg | 350/230/235 | |
| Wheels | 3.1 | Drive/castor/fork wheel | | | Powerfriction/Vulkollan/Vulkollan *) | |
| | 3.2 | Wheel size, front | | mm | Ø230x70 | |
| | 3.3 | Wheel size, rear | | mm | Ø85x95 | |
| | 3.4 | Additional wheels (dimensions) | | mm | Ø125x50 | |
| | 3.5 | Wheels, number front/rear (x=driven wheels) | | | 1x+2/2 | |
| | 3.6 | Track width, front | b ₁₀ | mm | 550 | |
| | 3.7 | Track width, rear | b ₁₁ | mm | 390 | |
| Dimensions | 4.2 | Height, mast lowered | h ₁ | mm | 2151 *) | |
| | 4.3 | Free lift | h ₂ | mm | 166 *) | |
| | 4.4 | Lift | h ₃ | mm | 3210 *) | |
| | | Lift height | h ₂₃ | mm | 3300 *) | |
| | 4.5 | Height, mast extended | h ₄ | mm | 3736 *) | |
| | 4.8 | Stand height (optional platform) | h ₇ | mm | 150 | |
| | 4.9 | Height of tiller in drive position, min./max. | h ₁₄ | mm | 865/1235 | |
| | 4.15 | Height, fork lowered | h ₁₃ | mm | 90 | |
| | 4.19 | Overall length | l ₁ | mm | 1831 | |
| | 4.20 | Length to face of forks | l ₂ | mm | 681 | |
| | 4.21 | Overall width | b ₁ | mm | 770 | |
| | 4.22 | Fork dimensions | s/e/l | mm | 60/180/1150 *) | |
| | 4.24 | Fork-carriage width | b ₃ | mm | 674 | |
| | 4.25 | Width over forks | b ₅ | mm | 570 *) | |
| | Performance data | 5.1 | Travel speed, with/without load | | km/h | 6/6 |
| 5.2 | | Lift speed, with/without load | | m/s | 0.14/0.28 | |
| 5.3 | | Lowering speed, with/without load | | m/s | 0.38/0.38 | |
| 5.8 | | Max. gradeability, with/without load ²⁾ | | % | 8/12 ¹⁾ | |
| 5.10 | | Service brake | | | Electromagnetic | |
| Electric motor | | 6.1 | Drive motor rating S2 60 min | | kW | 1.0 |
| | | 6.2 | Lift motor rating at S3 15% | | kW | 2.2 ²⁾ |
| | | 6.4 | Battery voltage/nominal capacity K _s | | V/Ah | 24/150 *) |
| | | 6.5 | Battery weight | | kg | 158 *) |
| | | Others | 8.1 | Type of drive control | | |

¹⁾ Measured according to company standard

²⁾ S3 6%

*) Further alternatives are available and will produce other values.

Data is based on standard configurations: Small battery compartment, h₂₃ = 3300 mm Duplex Tele mast.

Truck performance and dimensions are nominal and subject to tolerances. BT Products AB products and specifications are subject to change without notice.

Battery dependent dimensions

| Dimensions | | Battery Compartment | | SWE100 | | |
|------------|--|---------------------|------|-------------------|-------------------|-------------------|
| | | | | Small | Medium | Large |
| 1.9 | Wheelbase | y | mm | 1184 | 1241 | 1291 |
| 4.19 | Overall length without platform with platform up/down | l_1 | mm | 1831 1916/2306 | 1888 1973/2363 | 1938 2023/2413 |
| 4.20 | Length to face of forks without platform with platform up/down | l_2 | mm | 681 766/1156 | 738 823/1213 | 788 873/1263 |
| 4.33 | Aisle width for pallets 1000x1200 crossways without platform with platform up/down | A_{st} | mm | 2319 2404/2804 | 2375 2460/2860 | 2424 2509/2909 |
| 4.34 | Aisle width for pallets 800x1200 lengthways without platform with platform up/down | A_{st} | mm | 2216 2301/2701 | 2272 2357/2757 | 2321 2406/2806 |
| 4.35 | Turning radius without platform with platform up/down | W_a | mm | 1346 1431/1831 | 1402 1487/1887 | 1451 1536/1936 |
| 6.4 | Battery voltage, nominal capacity K_5 | | V/Ah | 24/150 | 24/225 | 24/300 |
| 6.5 | Battery weight, min.—max. | | kg | 120—165 | 180—220 | 220—270 |

Mast dimensions

| SWE100 | | | Simplex | | Duplex Tele | | | Duplex Tele Panoramic View | | |
|----------|-----------------------------------|----|---------|------|-------------|------|------|----------------------------|------|------|
| h_{23} | Lift height ($h_{13}+h_3$) | mm | 1400 | 1700 | 2700 | 2900 | 3300 | 2700 | 2900 | 3300 |
| h_3 | Lift | mm | 1310 | 1610 | 2610 | 2810 | 3210 | 2610 | 2810 | 3210 |
| h_1 | Height, mast lowered | mm | 1825 | 2125 | 1851 | 1951 | 2151 | 1835 | 1935 | 2135 |
| h_2 | Free lift, ground to top of forks | mm | 1400 | 1700 | 166 | 166 | 166 | 166 | 166 | 166 |
| h_4 | Height, mast extended | mm | 1825 | 2125 | 3136 | 3336 | 3736 | 3120 | 3320 | 3720 |

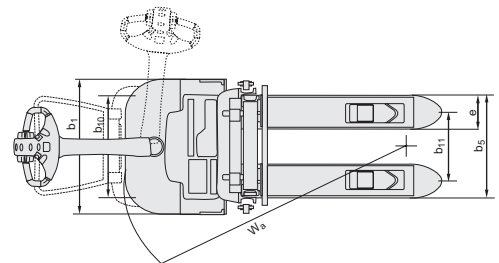
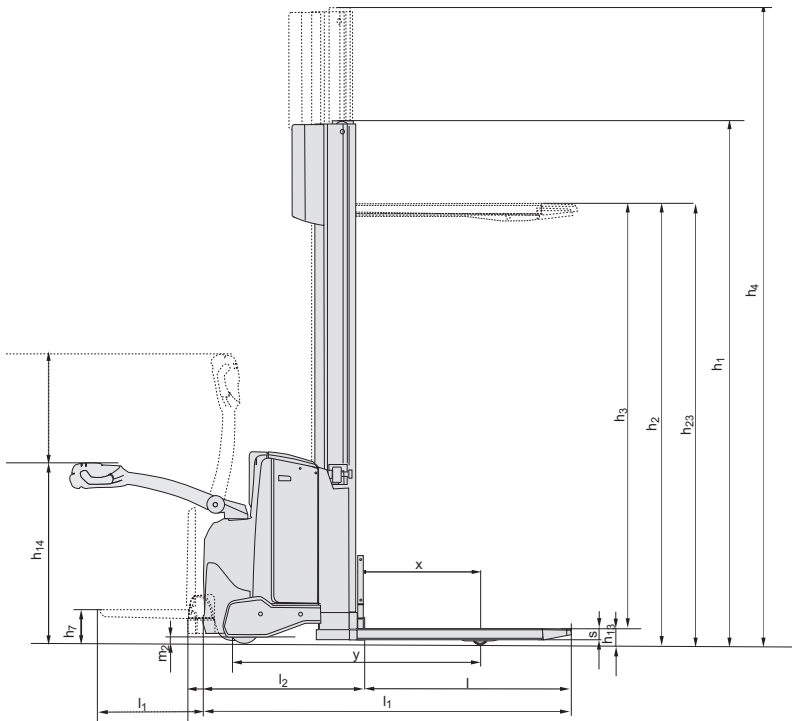

Pedestrian stacker truck 1.2 ton



BT staxio
SWE120S



email: info@forstor.com.ua

site: www.forstor.com.ua

TOYOTA

MATERIAL HANDLING

stronger together

Pedestrian stacker straddle version

| Specification for stacker trucks | | | | | SWE120S |
|----------------------------------|---|---|----------------------------------|------|----------------------------|
| Identification | 1.1 | Manufacturer | | | BT |
| | 1.2 | Model | | | SWE120S |
| | 1.3 | Drive | | | Electric |
| | 1.4 | Operator type | | | Pedestrian |
| | 1.5 | Load capacity/rated load | Q | kg | 1200 |
| | 1.6 | Load centre | c | mm | 600 |
| | 1.8 | Load distance, centre of support arm wheel to face of forks | x | mm | 561 |
| | 1.9 | Wheelbase | y | mm | 1208 |
| | Weight | 2.1 | Service weight including battery | | kg |
| 2.2 | | Axle load, with load, drive/support arm wheel | | kg | 635/1580 |
| 2.3 | | Axle load, without load, drive/support arm wheel | | kg | 675/340 |
| Wheels | 3.1 | Drive/support arm wheel | | | Powerfriction/Vulkollan *) |
| | 3.2 | Wheel size, front | | mm | Ø230x70 |
| | 3.3 | Wheel size, rear | | mm | Ø100x73 |
| | 3.5 | Wheels, number front/rear (x=driven wheels) | | | 1x2 |
| | 3.7 | Track width, rear | b_{10} | mm | 1000 |
| Dimensions | 4.2 | Height, mast lowered | h_1 | mm | 1832 *) |
| | 4.3 | Free lift | h_2 | mm | 1380 *) |
| | 4.4 | Lift | h_3 | mm | 2655 *) |
| | | Lift height | h_{23} | mm | 2655 *) |
| | 4.5 | Height, mast extended | h_4 | mm | 3226 *) |
| | 4.8 | Stand height (optional platform) | h_7 | mm | 150 |
| | 4.9 | Height of tiller in drive position, min./max. | h_{14} | mm | 865/1235 |
| | 4.10 | Height of support arm | h_{10} | mm | 100 |
| | 4.15 | Height, fork lowered | h_{13} | mm | 50 |
| | 4.19 | Overall length | l_1 | mm | 1946 |
| | 4.20 | Length to face of forks | l_2 | mm | 796 |
| | 4.21 | Overall width | b_1/b_2 | mm | 770/1100 *) |
| | 4.22 | Fork dimensions | $s/e/l$ | mm | 40/100/1150 *) |
| | 4.24 | Fork-carriage width | b_3 | mm | 840 |
| | 4.25 | Width over forks | b_5 | mm | 252—800 |
| | 4.26 | Distance between support arms | b_4 | mm | 900 *) |
| | 4.31 | Ground clearance, with load, below mast | m_1 | mm | 32 |
| 4.32 | Ground clearance, centre of wheelbase | m_2 | mm | 40 | |
| 4.33 | Aisle width for pallets 1000x1200 crossways | A_{st} | mm | 2400 | |
| 4.34 | Aisle width for pallets 800x1200 lengthways | A_{st} | mm | 2313 | |
| 4.35 | Turning radius | W_a | mm | 1359 | |
| Performance data | 5.1 | Travel speed, with/without load | | km/h | 6/6 |
| | 5.2 | Lift speed, with/without load | | m/s | 0.11/0.21 |
| | 5.3 | Lowering speed, with/without load | | m/s | 0.33/0.24 |
| | 5.8 | Max. gradeability, with/without load | | % | 8/10 ¹⁾ |
| | 5.10 | Service brake | | | Electromagnetic |
| Electric motor | 6.1 | Drive motor rating S2 60 min | | kW | 1.0 |
| | 6.2 | Lift motor rating at S3 15% | | kW | 2.2 ²⁾ |
| | 6.4 | Battery voltage/nominal capacity K_s | | V/Ah | 24/225 *) |
| | 6.5 | Battery weight | | kg | 214 *) |
| Others | 8.1 | Type of drive control | | | BT Powerdrive |

¹⁾ Measured according to company standard

²⁾ S3 6%

*) Further alternatives are available and will produce other values.

Data is based on standard configurations: Medium battery compartment, h_{23} = 2655 mm Duplex HiLo mast.

Truck performance and dimensions are nominal and subject to tolerances. BT Products AB products and specifications are subject to change without notice.

Battery dependent dimensions

BT staxio

| Dimensions | | Battery Compartment | | SWE120S | |
|------------|--|---------------------|------|-----------|-----------|
| | | | | Medium | Large |
| 1.9 | Wheelbase | y | mm | 1208 | 1258 |
| 4.19 | Overall length | l ₁ | mm | 1946 | 1996 |
| | without platform | | | 2031/2421 | 2081/2471 |
| 4.20 | Length to face of forks | l ₂ | mm | 796 | 846 |
| | without platform | | | 881/1271 | 931/1321 |
| 4.33 | Aisle width for pallets 1000x1200 crossways | A _{st} | mm | 2400 | 2449 |
| | without platform | | | 2485/2885 | 2534/2934 |
| 4.34 | Aisle width for pallets 800x1200 lengthways | A _{st} | mm | 2313 | 2362 |
| | without platform | | | 2398/2798 | 2447/2847 |
| 4.35 | Turning radius | W _a | mm | 1359 | 1408 |
| | without platform | | | 1444/1844 | 1493/1893 |
| 6.4 | Battery voltage, nominal capacity K ₅ | | V/Ah | 24/225 | 24/300 |
| 6.5 | Battery weight, min.—max. | | kg | 180—220 | 220—270 |

Mast dimensions

| SWE120S | | Simplex | | Duplex Tele | | | | Dupl. Tele Panor. View | | | | Duplex HiLo | | | | Triplex HiLo | | | |
|-----------------|--|---------|-----------|--------------------------|--------------------------|--------------------------|--------------------------|--------------------------|--------------------------|--------------------------|--------------------------|-------------|--|--|--|--------------|--|--|--|
| h ₂₃ | Lift height (h ₁₃ +h ₃) | mm | 1355 1655 | 2655 2855 3255 3655 4105 | 2655 2855 3255 3655 4105 | 2655 2855 3255 3655 4105 | 2655 2855 3255 3655 4105 | 2655 2855 3255 3655 4105 | 2655 2855 3255 3655 4105 | 2655 2855 3255 3655 4105 | 3255 3655 4105 4455 4755 | | | | | | | | |
| h ₃ | Lift | mm | 1305 1605 | 2605 2805 3205 3605 4005 | 2605 2805 3205 3605 4005 | 2605 2805 3205 3605 4005 | 2605 2805 3205 3605 4005 | 2605 2805 3205 3605 4005 | 2605 2805 3205 3605 4005 | 3205 3605 4005 4405 4705 | | | | | | | | | |
| h ₁ | Height, mast lowered | mm | 1822 2122 | 1837 1937 2137 2337 2562 | 1832 1932 2132 2332 2557 | 1832 1932 2132 2332 2557 | 1832 1932 2132 2332 2557 | 1832 1932 2132 2332 2557 | 1832 1932 2132 2332 2557 | 1692 1826 1976 2092 2192 | | | | | | | | | |
| h ₂ | Free lift, ground to top of forks | mm | 1355 1655 | 126 126 126 126 126 | 126 126 126 126 126 | 126 126 126 126 126 | 126 126 126 126 126 | 126 126 126 126 126 | 126 126 126 126 126 | 1230 1364 1514 1630 1730 | | | | | | | | | |
| h ₄ | Height, mast extended | mm | 1901 2201 | 3205 3405 3805 4205 4655 | 3205 3405 3805 4205 4655 | 3205 3405 3805 4205 4655 | 3205 3405 3805 4205 4655 | 3205 3405 3805 4205 4655 | 3226 3426 3826 4226 4676 | 3822 4224 4674 5022 5322 | | | | | | | | | |

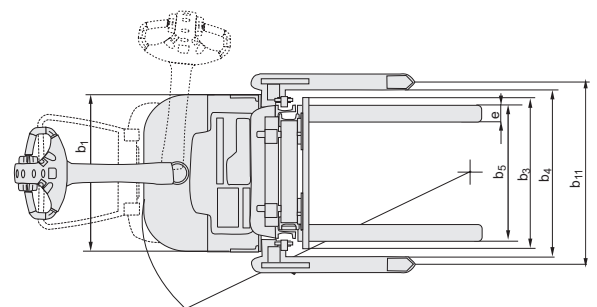
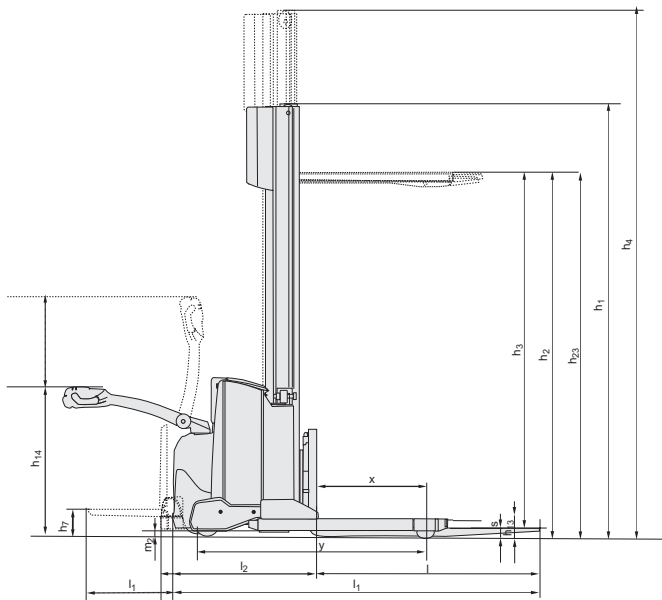

Pedestrian stacker truck 1.2 - 1.4 ton



BT staxio

SWE120

SWE140



email: info@forstor.com.ua

site: www.forstor.com.ua

TOYOTA

MATERIAL HANDLING

stronger together

Pedestrian stacker

| Specification for stacker trucks | | | | | SWE120 | SWE140 |
|----------------------------------|---|---|----------------------------------|------|--------------------------------------|--------------------|
| Identification | 1.1 | Manufacturer | | | BT | BT |
| | 1.2 | Model | | | SWE120 | SWE140 |
| | 1.3 | Drive | | | Electric | Electric |
| | 1.4 | Operator type | | | Pedestrian | Pedestrian |
| | 1.5 | Load capacity/rated load | Q | kg | 1200 | 1400 |
| | 1.6 | Load centre | c | mm | 600 | 600 |
| | 1.8 | Load distance, centre of support arm wheel to face of forks | x | mm | 645 | 645 |
| | 1.9 | Wheelbase | y | mm | 1252 | 1252 |
| | Weight | 2.1 | Service weight including battery | | kg | 929 |
| 2.2 | | Axle load, with load, drive/castor/support arm wheel | | kg | 400/290/1445 | 450/245/1640 |
| 2.3 | | Axle load, without load, drive/castor/support arm wheel | | kg | 400/250/285 | 450/200/285 |
| Wheels | 3.1 | Drive/castor/fork wheel | | | Powerfriction/Vulkollan/Vulkollan *) | |
| | 3.2 | Wheel size, front | | mm | Ø230x70 | Ø230x70 |
| | 3.3 | Wheel size, rear | | mm | Ø85x95 | Ø85x95 |
| | 3.4 | Additional wheels (dimensions) | | mm | Ø125x50 | Ø125x50 |
| | 3.5 | Wheels, number front/rear (x=driven wheels) | | | 1x+2/2 | 1x+2/2 |
| | 3.6 | Track width, front | b ₁₀ | mm | 550 | 550 |
| | 3.7 | Track width, rear | b ₁₁ | mm | 390 | 390 |
| Dimensions | 4.2 | Height, mast lowered | h ₁ | mm | 2135 *) | 2160 *) |
| | 4.3 | Free lift | h ₂ | mm | 166 *) | 166 *) |
| | 4.4 | Lift | h ₃ | mm | 3210 *) | 3165 *) |
| | | Lift height | h ₂₃ | mm | 3300 *) | 3255 *) |
| | 4.5 | Height, mast extended | h ₄ | mm | 3740 *) | 3725 *) |
| | 4.8 | Stand height (optional platform) | h ₇ | mm | 150 | 150 |
| | 4.9 | Height of tiller in drive position, min./max. | h ₁₄ | mm | 865/1235 | 865/1235 |
| | 4.15 | Height, fork lowered | h ₁₃ | mm | 90 | 90 |
| | 4.19 | Overall length | l ₁ | mm | 1906 | 1901 |
| | 4.20 | Length to face of forks | l ₂ | mm | 756 | 751 |
| | 4.21 | Overall width | b ₁ | mm | 770 | 770 *) |
| | 4.22 | Fork dimensions | s/e/l | mm | 60/180/1150 *) | 70/180/1150 *) |
| | 4.24 | Fork-carriage width | b ₃ | mm | 674 | 674 |
| | 4.25 | Width over forks | b ₅ | mm | 570 *) | 570 *) |
| | 4.31 | Ground clearance, with load, below mast | m ₁ | mm | 27 | 27 |
| | 4.32 | Ground clearance, centre of wheelbase | m ₂ | mm | 27 | 27 |
| | 4.33 | Aisle width for pallets 1000x1200 crossways | A _{st} | mm | 2386 | 2381 |
| 4.34 | Aisle width for pallets 800x1200 lengthways | A _{st} | mm | 2286 | 2281 | |
| 4.35 | Turning radius | W _a | mm | 1402 | 1397 | |
| Performance data | 5.1 | Travel speed, with/without load | | km/h | 6/6 | 6/6 |
| | 5.2 | Lift speed, with/without load | | m/s | 0.12/0.28 | 0.11/0.28 |
| | 5.3 | Lowering speed, with/without load | | m/s | 0.38/0.38 | 0.37/0.38 |
| | 5.8 | Max. gradeability, with/without load | | % | 8/12 ¹⁾ | 8/12 ¹⁾ |
| | 5.10 | Service brake | | | Electromagnetic | Electromagnetic |
| Electric motor | 6.1 | Drive motor rating S2 60 min | | kW | 1.0 | 1.5 |
| | 6.2 | Lift motor rating at S3 15% | | kW | 2.2 ²⁾ | 2.2 ²⁾ |
| | 6.4 | Battery voltage/nominal capacity K _s | | V/Ah | 24/225 *) | 24/225 *) |
| | 6.5 | Battery weight | | kg | 214 *) | 214 *) |
| Others | 8.1 | Type of drive control | | | BT Powerdrive | BT Powerdrive |

¹⁾ Measured according to company standard

²⁾ S3 6%

*) Further alternatives are available and will produce other values.

Data is based on standard configurations: Medium battery compartment, h₂₃ = 3300 mm (SWE120) and 3255 mm (SWE140) Duplex Tele Panoramic View mast.

Truck performance and dimensions are nominal and subject to tolerances. BT Products AB products and specifications are subject to change without notice.

Battery dependent dimensions

BT staxio

| Dimensions | | Battery change | | SWE120 | | | SWE140 | | |
|------------|--|---------------------|------|-------------------|-------------------|-------------------|-------------------|-------------------|-------------------|
| | | | | Lift out | | Sideways | Lift out | | Sideways |
| | | Battery compartment | | Medium | Large | Large | Medium | Large | Large |
| 1.9 | Wheelbase | y | mm | 1252 | 1302 | 1302 | 1247 | 1297 | 1297 |
| 4.19 | Overall length without platform with platform up/down | l_1 | mm | 1906 1991/2381 | 1956 2041/2431 | 1956 2041/2431 | 1901 1986/2376 | 1951 2036/2426 | 1951 2036/2426 |
| 4.20 | Length to face of forks without platform with platform up/down | l_2 | mm | 756 841/1231 | 806 891/1281 | 806 891/1281 | 751 836/1226 | 801 886/1276 | 801 886/1276 |
| 4.33 | Aisle width for pallets 1000x1200 crossways without platform with platform up/down | A_{st} | mm | 2386 2471/2871 | 2435 2520/2920 | 2435 2520/2920 | 2381 2466/2866 | 2431 2516/2916 | 2431 2516/2916 |
| 4.34 | Aisle width for pallets 800x1200 lengthways without platform with platform up/down | A_{st} | mm | 2286 2371/2771 | 2335 2420/2820 | 2335 2420/2820 | 2281 2366/2766 | 2331 2416/2816 | 2331 2416/2816 |
| 4.35 | Turning radius without platform with platform up/down | W_a | mm | 1402 1487/1887 | 1451 1536/1936 | 1451 1536/1936 | 1397 1482/1882 | 1447 1532/1932 | 1447 1532/1932 |
| 6.4 | Battery voltage, nominal capacity K_5 | | V/Ah | 24/225 | 24/300 | 24/260 | 24/225 | 24/300 | 24/260 |
| 6.5 | Battery weight, min.—max. | | kg | 180—220 | 220—270 | 220—230 | 180—220 | 220—270 | 220—230 |

Mast dimensions

| SWE120 | | | Simplex | Duplex Tele | | | | | Dupl. Tele Panor. View | | | | | Duplex HiLo | | | | | Triplex HiLo | | | |
|----------|-----------------------------------|----|-----------|--------------------------|--------------------------|--------------------------|--------------------------|--------------------------|------------------------|--|--|--|--|-------------|--|--|--|--|--------------|--|--|--|
| h_{23} | Lift height ($h_{13}+h_3$) | mm | 1400 1700 | 2700 2900 3300 3700 4150 | 2700 2900 3300 3700 4150 | 2700 2900 3300 3700 4150 | 2700 2900 3300 3700 4150 | 2700 2900 3300 3700 4150 | 3300 3700 4150 4500 | | | | | | | | | | | | | |
| h_3 | Lift | mm | 1310 1610 | 2610 2810 3210 3610 4060 | 2610 2810 3210 3610 4060 | 2610 2810 3210 3610 4060 | 2610 2810 3210 3610 4060 | 2610 2810 3210 3610 4060 | 3210 3610 4060 4410 | | | | | | | | | | | | | |
| h_1 | Height, mast lowered | mm | 1825 2125 | 1840 1940 2140 2340 2565 | 1835 1935 2135 2335 2560 | 1835 1935 2135 2335 2560 | 1835 1935 2135 2335 2560 | 1695 1829 1979 2095 | | | | | | | | | | | | | | |
| h_2 | Free lift, ground to top of forks | mm | 1400 1700 | 166 166 166 166 166 | 166 166 166 166 166 | 166 166 166 166 166 | 166 166 166 166 166 | 1420 1520 1720 1920 2144 | 1270 1404 1554 1670 | | | | | | | | | | | | | |
| h_4 | Height, mast extended | mm | 1836 2136 | 3140 3340 3740 4140 4590 | 3140 3340 3740 4140 4590 | 3140 3340 3740 4140 4590 | 3161 3361 3761 4161 4611 | 3757 4159 4609 4957 | | | | | | | | | | | | | | |

| SWE140 | | | Duplex Tele Panoramic View | | | | | Duplex HiLo | | | | | Triplex HiLo | | | | |
|----------|-----------------------------------|----|----------------------------|--------------------------|--------------------------|--------------------------|--------------------------|--------------------------|--|--|--|--|--------------|--|--|--|--|
| h_{23} | Lift height ($h_{13}+h_3$) | mm | 2655 2855 3255 3655 4105 | 2655 2855 3255 3655 4105 | 2655 2855 3255 3655 4105 | 2655 2855 3255 3655 4105 | 2655 2855 3255 3655 4105 | 3255 3655 4105 4455 4755 | | | | | | | | | |
| h_3 | Lift | mm | 2565 2765 3165 3565 4015 | 2565 2765 3165 3565 4015 | 2565 2765 3165 3565 4015 | 2565 2765 3165 3565 4015 | 2565 2765 3165 3565 4015 | 3165 3565 4015 4365 4665 | | | | | | | | | |
| h_1 | Height, mast lowered | mm | 1860 1960 2160 2360 2585 | 1835 1935 2135 2335 2560 | 1835 1935 2135 2335 2560 | 1835 1935 2135 2335 2560 | 1695 1829 1979 2095 2195 | | | | | | | | | | |
| h_2 | Free lift, ground to top of forks | mm | 166 166 166 166 166 | 1374 1474 1674 1874 2099 | 1224 1358 1508 1624 1724 | 1224 1358 1508 1624 1724 | 1224 1358 1508 1624 1724 | | | | | | | | | | |
| h_4 | Height, mast extended | mm | 3125 3325 3725 4125 4575 | 3141 3341 3741 4141 4591 | 3747 4149 4599 4947 5247 | 3747 4149 4599 4947 5247 | 3747 4149 4599 4947 5247 | | | | | | | | | | |

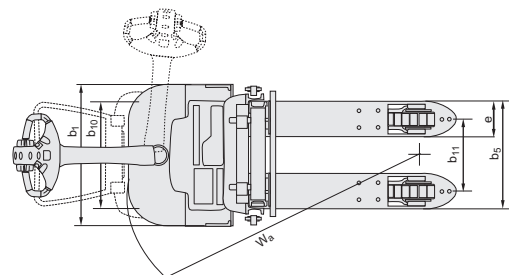
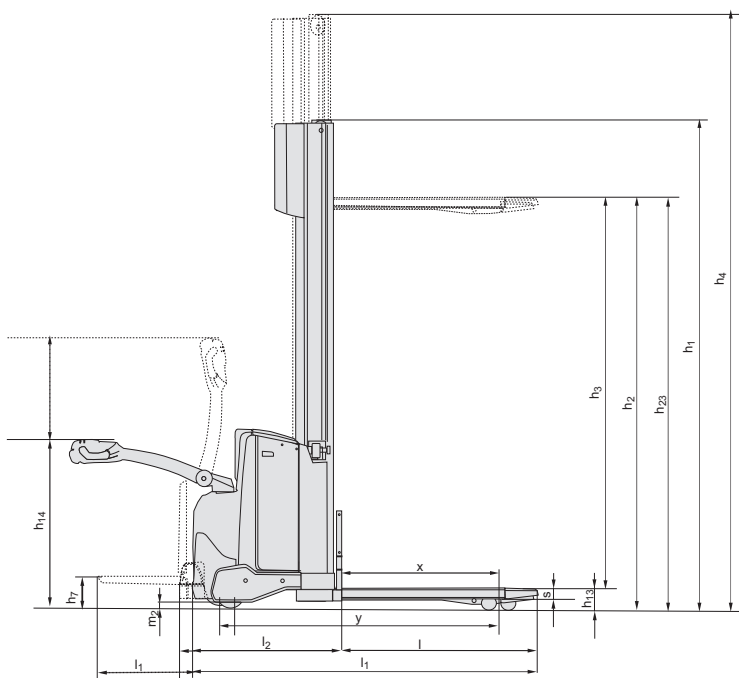

Pedestrian stacker truck 1.2 - 1.4 ton



BT staxio

SWE120L

SWE140L



email: info@forstor.com.ua

site: www.forstor.com.ua

TOYOTA

MATERIAL HANDLING

stronger together

Pedestrian stacker with elevating support arms

| Specification for stacker trucks | | | | | SWE120L | SWE140L |
|----------------------------------|---|---|-----------------|------|--------------------------------------|--------------------|
| Identification | 1.1 | Manufacturer | | | BT | BT |
| | 1.2 | Model | | | SWE120L | SWE140L |
| | 1.3 | Drive | | | Electric | Electric |
| | 1.4 | Operator type | | | Pedestrian | Pedestrian |
| | 1.5 | Load capacity/rated load | Q | kg | 1200 | 1400 |
| | | Support arm capacity/fork and support arm capacity | Q | kg | 1600/— | 1600/— |
| | 1.6 | Load centre | c | mm | 600 | 600 |
| | 1.8 | Load distance, centre of support arm wheel to face of forks | x | mm | 672 | 672 |
| | 1.9 | Wheelbase | y | mm | 1282 | 1282 |
| Weight | 2.1 | Service weight including battery | | kg | 929 | 929 |
| | 2.2 | Axle load, with load, drive/castor/support arm wheel | | kg | 450/340/1345 | 450/360/1525 |
| | 2.3 | Axle load, without load, drive/castor/support arm wheel | | kg | 450/220/265 | 450/220/265 |
| Wheels | 3.1 | Drive/castor/fork wheel | | | Powerfriction/Vulkollan/Vulkollan *) | |
| | 3.2 | Wheel size, front | | mm | Ø230x70 | Ø230x70 |
| | 3.3 | Wheel size, rear | | mm | Ø85x74 | Ø85x74 |
| | 3.4 | Additional wheels (dimensions) | | mm | Ø125x50 | Ø125x50 |
| | 3.5 | Wheels, number front/rear (x=driven wheels) | | | 1x+2/4 | 1x+2/4 |
| | 3.6 | Track width, front | b ₁₀ | mm | 550 | 550 |
| | 3.7 | Track width, rear | b ₁₁ | mm | 390 | 390 |
| Dimensions | 4.2 | Height, mast lowered | h ₁ | mm | 2135 *) | 2160 *) |
| | 4.3 | Free lift | h ₂ | mm | 166 *) | 166 *) |
| | 4.4 | Lift | h ₃ | mm | 3210 *) | 3165 *) |
| | | Lift height | h ₂₃ | mm | 3300 *) | 3255 *) |
| | 4.5 | Height, mast extended | h ₄ | mm | 3740 *) | 3725 *) |
| | 4.6 | Initial lift | h ₅ | mm | 120 | 120 |
| | 4.8 | Stand height (optional platform) | h ₇ | mm | 150 | 150 |
| | 4.9 | Height of tiller in drive position, min./max. | h ₁₄ | mm | 865/1235 | 865/1235 |
| | 4.15 | Height, fork lowered | h ₁₃ | mm | 90 | 90 |
| | 4.19 | Overall length | l ₁ | mm | 1910 | 1910 |
| | 4.20 | Length to face of forks | l ₂ | mm | 760 | 760 |
| | 4.21 | Overall width | b ₁ | mm | 770 | 770 *) |
| | 4.22 | Fork dimensions | s/e/l | mm | 60/180/1150 *) | 70/180/1150 *) |
| | 4.24 | Fork-carriage width | b ₃ | mm | 674 | 674 |
| | 4.25 | Width over forks | b ₅ | mm | 570 *) | 570 *) |
| | 4.31 | Ground clearance, with load, below mast | m ₁ | mm | 22 | 22 |
| | 4.32 | Ground clearance, centre of wheelbase | m ₂ | mm | 22 | 22 |
| 4.33 | Aisle width for pallets 1000x1200 crossways | A _{st} | mm | 2400 | 2400 | |
| 4.34 | Aisle width for pallets 800x1200 lengthways | A _{st} | mm | 2295 | 2295 | |
| 4.35 | Turning radius | W _a | mm | 1433 | 1433 | |
| Performance data | 5.1 | Travel speed, with/without load | | km/h | 6/6 | 6/6 |
| | 5.2 | Lift speed, with/without load | | m/s | 0.12/0.27 | 0.11/0.27 |
| | 5.3 | Lowering speed, with/without load | | m/s | 0.38/0.32 | 0.37/0.32 |
| | 5.8 | Max. gradeability, with/without load | | % | 9/12 ¹⁾ | 8/12 ¹⁾ |
| | 5.10 | Service brake | | | Electromagnetic | Electromagnetic |
| Electric motor | 6.1 | Drive motor rating S2 60 min | | kW | 1.5 | 1.5 |
| | 6.2 | Lift motor rating at S3 15% | | kW | 2.2 ²⁾ | 2.2 ²⁾ |
| | 6.4 | Battery voltage/nominal capacity K _s | | V/Ah | 24/225 *) | 24/225 *) |
| | 6.5 | Battery weight | | kg | 214 *) | 214 *) |
| Others | 8.1 | Type of drive control | | | BT Powerdrive | BT Powerdrive |

¹⁾ Measured according to company standard

²⁾ S3 6%

*) Further alternatives are available and will produce other values.

Data is based on standard configurations: Medium battery compartment, h₂₃ = 3300 mm (SWE120L) and 3255 mm (SWE140L) Duplex Tele Panoramic View mast.

Truck performance and dimensions are nominal and subject to tolerances. BT Products AB products and specifications are subject to change without notice.

Battery dependent dimensions

BT staxio

| Dimensions | | Battery change | | SWE120L | | | SWE140L | | |
|------------|--|---------------------|------|-------------------|-------------------|-------------------|-------------------|-------------------|-------------------|
| | | | | Lift out | | Sideways | Lift out | | Sideways |
| | | Battery compartment | | Medium | Large | Large | Medium | Large | Large |
| 1.9 | Wheelbase | y | mm | 1282 | 1332 | 1332 | 1282 | 1332 | 1332 |
| 4.19 | Overall length without platform with platform up/down | l_1 | mm | 1910 1995/2385 | 1960 2045/2435 | 1960 2045/2435 | 1910 1995/2385 | 1960 2045/2435 | 1960 2045/2435 |
| 4.20 | Length to face of forks without platform with platform up/down | l_2 | mm | 760 845/1235 | 810 895/1285 | 810 895/1285 | 760 845/1235 | 810 895/1285 | 810 895/1285 |
| 4.33 | Aisle width for pallets 1000x1200 crossways without platform with platform up/down | A_{st} | mm | 2400 2485/2885 | 2449 2534/2934 | 2449 2534/2934 | 2400 2485/2885 | 2449 2534/2934 | 2449 2534/2934 |
| 4.34 | Aisle width for pallets 800x1200 lengthways without platform with platform up/down | A_{st} | mm | 2295 2380/2780 | 2344 2429/2829 | 2344 2429/2829 | 2295 2380/2780 | 2344 2429/2829 | 2344 2429/2829 |
| 4.35 | Turning radius without platform with platform up/down | W_a | mm | 1433 1518/1918 | 1482 1567/1967 | 1482 1567/1967 | 1433 1518/1918 | 1482 1567/1967 | 1482 1567/1967 |
| 6.4 | Battery voltage, nominal capacity K_5 | | V/Ah | 24/225 | 24/300 | 24/260 | 24/225 | 24/300 | 24/260 |
| 6.5 | Battery weight, min.—max. | | kg | 180—220 | 220—270 | 220—230 | 180—220 | 220—270 | 220—230 |

Mast dimensions

| SWE120L | | | Simplex | Duplex Tele | | | Dupl. Tele Panoram. View | | | Duplex HiLo | | | Triplex HiLo | | |
|----------|-----------------------------------|----|-----------|--------------------------|--------------------------|--------------------------|--------------------------|--------------------------|---------------------|-------------|--|--|--------------|--|--|
| h_{23} | Lift height (h13+h3) | mm | 1400 1700 | 2700 2900 3300 3700 4150 | 2700 2900 3300 3700 4150 | 2700 2900 3300 3700 4150 | 2700 2900 3300 3700 4150 | 2700 2900 3300 3700 4150 | 3300 3700 4150 4500 | | | | | | |
| h_3 | Lift | mm | 1310 1610 | 2610 2810 3210 3610 4060 | 2610 2810 3210 3610 4060 | 2610 2810 3210 3610 4060 | 2610 2810 3210 3610 4060 | 3210 3610 4060 4410 | | | | | | | |
| h_1 | Height, mast lowered | mm | 1825 2125 | 1840 1940 2140 2340 2565 | 1835 1935 2135 2335 2560 | 1835 1935 2135 2335 2560 | 1835 1935 2135 2335 2560 | 1695 1829 1979 2095 | | | | | | | |
| h_2 | Free lift, ground to top of forks | mm | 1400 1700 | 166 166 166 166 166 | 166 166 166 166 166 | 166 166 166 166 166 | 166 166 166 166 166 | 1420 1520 1720 1920 2144 | 1270 1404 1554 1670 | | | | | | |
| h_4 | Height, mast extended | mm | 1836 2136 | 3140 3340 3740 4140 4590 | 3140 3340 3740 4140 4590 | 3140 3340 3740 4140 4590 | 3161 3361 3761 4161 4611 | 3757 4159 4609 4957 | | | | | | | |

| SWE140L | | | Duplex Tele Panoramic View | | | Duplex HiLo | | | Triplex HiLo | | |
|----------|-----------------------------------|----|----------------------------|--------------------------|--------------------------|--------------------------|--------------------------|--------------------------|--------------|--|--|
| h_{23} | Lift height (h13+h3) | mm | 2655 2855 3255 3655 4105 | 2655 2855 3255 3655 4105 | 2655 2855 3255 3655 4105 | 2655 2855 3255 3655 4105 | 2655 2855 3255 3655 4105 | 3255 3655 4105 4455 4755 | | | |
| h_3 | Lift | mm | 2565 2765 3165 3565 4015 | 2565 2765 3165 3565 4015 | 2565 2765 3165 3565 4015 | 2565 2765 3165 3565 4015 | 2565 2765 3165 3565 4015 | 3165 3565 4015 4365 4665 | | | |
| h_1 | Height, mast lowered | mm | 1860 1960 2160 2360 2585 | 1835 1935 2135 2335 2560 | 1835 1935 2135 2335 2560 | 1835 1935 2135 2335 2560 | 1695 1829 1979 2095 2195 | | | | |
| h_2 | Free lift, ground to top of forks | mm | 166 166 166 166 166 | 1374 1474 1674 1874 2099 | 1224 1358 1508 1624 1724 | 1224 1358 1508 1624 1724 | 1224 1358 1508 1624 1724 | | | | |
| h_4 | Height, mast extended | mm | 3125 3325 3725 4125 4575 | 3141 3341 3741 4141 4591 | 3747 4149 4599 4947 5247 | 3747 4149 4599 4947 5247 | 3747 4149 4599 4947 5247 | | | | |

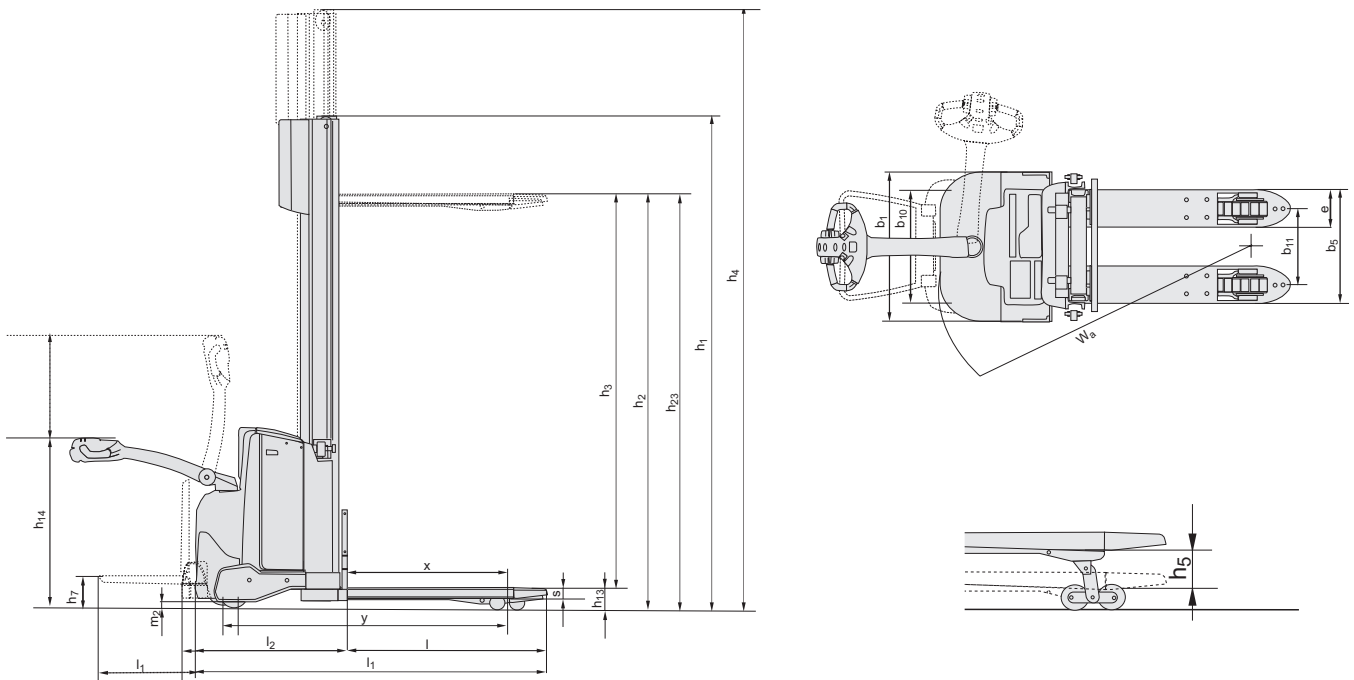

Pedestrian stacker truck 2.0 ton

BT staxio SWE200D



email: info@forstor.com.ua
site: www.forstor.com.ua

TOYOTA

MATERIAL HANDLING

stronger together

Pedestrian stacker double stacking

| Specification for stacker trucks | | | | | SWE200D |
|----------------------------------|---|---|-----------------|------|-----------------------------------|
| Identification | 1.1 | Manufacturer | | | BT |
| | 1.2 | Model | | | SWE200D |
| | 1.3 | Drive | | | Electric |
| | 1.4 | Operator type | | | Pedestrian |
| | 1.5 | Load capacity/rated load | Q | kg | 1000 |
| | | Support arm capacity/fork and support arm capacity | Q | kg | 2000/800+1200 |
| | 1.6 | Load centre | c | mm | 600 |
| | 1.8 | Load distance, centre of support arm wheel to face of forks | x | mm | 873 |
| | 1.9 | Wheelbase | y | mm | 1483 |
| Weight | 2.1 | Service weight including battery | | kg | 879 |
| | 2.2 | Axle load, with load, drive/castor/support arm wheel | | kg | 570/360/1155 |
| | 2.3 | Axle load, without load, drive/castor/support arm wheel | | kg | 570/100/215 |
| Wheels | 3.1 | Drive/castor/support arm wheel | | | Powerfriction/Vulkollan/Vulkollan |
| | 3.2 | Wheel size, front | | mm | Ø230x70 |
| | 3.3 | Wheel size, rear | | mm | Ø85x74 |
| | 3.4 | Additional wheels (dimensions) | | mm | Ø125x50 |
| | 3.5 | Wheels, number front/rear (x=driven wheels) | | | 1x+2/4 |
| | 3.6 | Track width, front | b ₁₀ | mm | 550 |
| | 3.7 | Track width, rear | b ₁₁ | mm | 390 |
| Dimensions | 4.2 | Height, mast lowered | h ₁ | mm | 1535 *) |
| | 4.3 | Free lift | h ₂ | mm | 166 *) |
| | 4.4 | Lift | h ₃ | mm | 2010 *) |
| | | Lift height | h ₂₃ | mm | 2100 *) |
| | 4.5 | Height, mast extended | h ₄ | mm | 2540 *) |
| | 4.6 | Initial lift | h ₅ | mm | 120 |
| | 4.8 | Stand height (optional platform) | h ₇ | mm | 150 |
| | 4.9 | Height of tiller in drive position, min./max. | h ₁₄ | mm | 865/1235 |
| | 4.15 | Height, fork lowered | h ₁₃ | mm | 90 |
| | 4.19 | Overall length | l ₁ | mm | 1910 |
| | 4.20 | Length to face of forks | l ₂ | mm | 760 |
| | 4.21 | Overall width | b ₁ | mm | 770 |
| | 4.22 | Fork dimensions | s/e/l | mm | 60/180/1150 *) |
| | 4.24 | Fork-carriage width | b ₃ | mm | 674 |
| | 4.25 | Width over forks | b ₅ | mm | 570 *) |
| | 4.31 | Ground clearance, with load, below mast | m ₁ | mm | 22 |
| | 4.32 | Ground clearance, centre of wheelbase | m ₂ | mm | 22 |
| 4.33 | Aisle width for pallets 1000 x 1200 crossways | A _{st} | mm | 2493 | |
| 4.34 | Aisle width for pallets 800 x 1200 lengthways | A _{st} | mm | 2349 | |
| 4.35 | Turning radius | W _a | mm | 1632 | |
| Performance data | 5.1 | Travel speed, with/without load | | km/h | 6/6 |
| | 5.2 | Lift speed, with/without load | | m/s | 0.14/0.27 |
| | 5.3 | Lowering speed, with/without load | | m/s | 0.38/0.32 |
| | 5.8 | Max. gradeability, with/without load | | % | 8/12 ¹⁾ |
| | 5.10 | Service brake | | | Electromagnetic |
| Electric motor | 6.1 | Drive motor rating S2 60 min | | kW | 1.5 |
| | 6.2 | Lift motor rating at S3 15% | | kW | 2.2 ²⁾ |
| | 6.4 | Battery voltage/nominal capacity K ₅ | | V/Ah | 24/225 *) |
| | 6.5 | Battery weight | | kg | 214 *) |
| | | | | | |
| Others | 8.1 | Type of drive control | | | BT Powerdrive |

¹⁾ Measured according to company standard

²⁾ S3 6%

*) Further alternatives are available and will produce other values.

Data is based on standard configurations: h₂₃ = 2100 mm Duplex Tele Panoramic View mast.

Truck performance and dimensions are nominal and subject to tolerances.
BT Products AB products and specifications are subject to change without notice.

Battery dependent dimensions

BT staxio

| Dimensions | | Battery change | | SWE200D | | |
|------------|--|---------------------|------|-------------------|-------------------|-------------------|
| | | | | Lift out | | Sideways |
| | | Battery compartment | | Medium | Large | Large |
| 1.9 | Wheelbase | y | mm | 1483 | 1533 | 1533 |
| 4.19 | Overall length without platform with platform up/down | l_1 | mm | 1910 1995/2385 | 1960 2045/2435 | 1960 2045/2435 |
| 4.20 | Length to face of forks without platform with platform up/down | l_2 | mm | 760 845/1235 | 810 895/1285 | 810 895/1285 |
| 4.33 | Aisle width for pallets 1000x1200 crossways without platform with platform up/down | A_{st} | mm | 2493 2578/2978 | 2542 2627/3027 | 2542 2627/3027 |
| 4.34 | Aisle width for pallets 800x1200 lengthways without platform with platform up/down | A_{st} | mm | 2349 2434/2834 | 2398 2483/2883 | 2398 2483/2883 |
| 4.35 | Turning radius without platform with platform up/down | W_a | mm | 1632 1717/2117 | 1681 1766/2166 | 1681 1766/2166 |
| 6.4 | Battery voltage, nominal capacity K_5 | | V/Ah | 24/225 | 24/300 | 24/260 |
| 6.5 | Battery weight, min.—max. | | kg | 180—220 | 220—270 | 220—230 |

Mast dimensions

| SWE200D | | | Duplex Tele | | | Dupl. Tele Panoram. View | | |
|----------|-----------------------------------|----|-------------|------|------|--------------------------|------|------|
| h_{23} | Lift height ($h_{13}+h_3$) | mm | 1700 | 1900 | 2100 | 1700 | 1900 | 2100 |
| h_3 | Lift | mm | 1610 | 1810 | 2010 | 1610 | 1810 | 2010 |
| h_1 | Height, mast lowered | mm | 1340 | 1440 | 1540 | 1335 | 1435 | 1535 |
| h_2 | Free lift, ground to top of forks | mm | 166 | 166 | 166 | 166 | 166 | 166 |
| h_4 | Height, mast extended | mm | 2140 | 2340 | 2540 | 2140 | 2340 | 2540 |

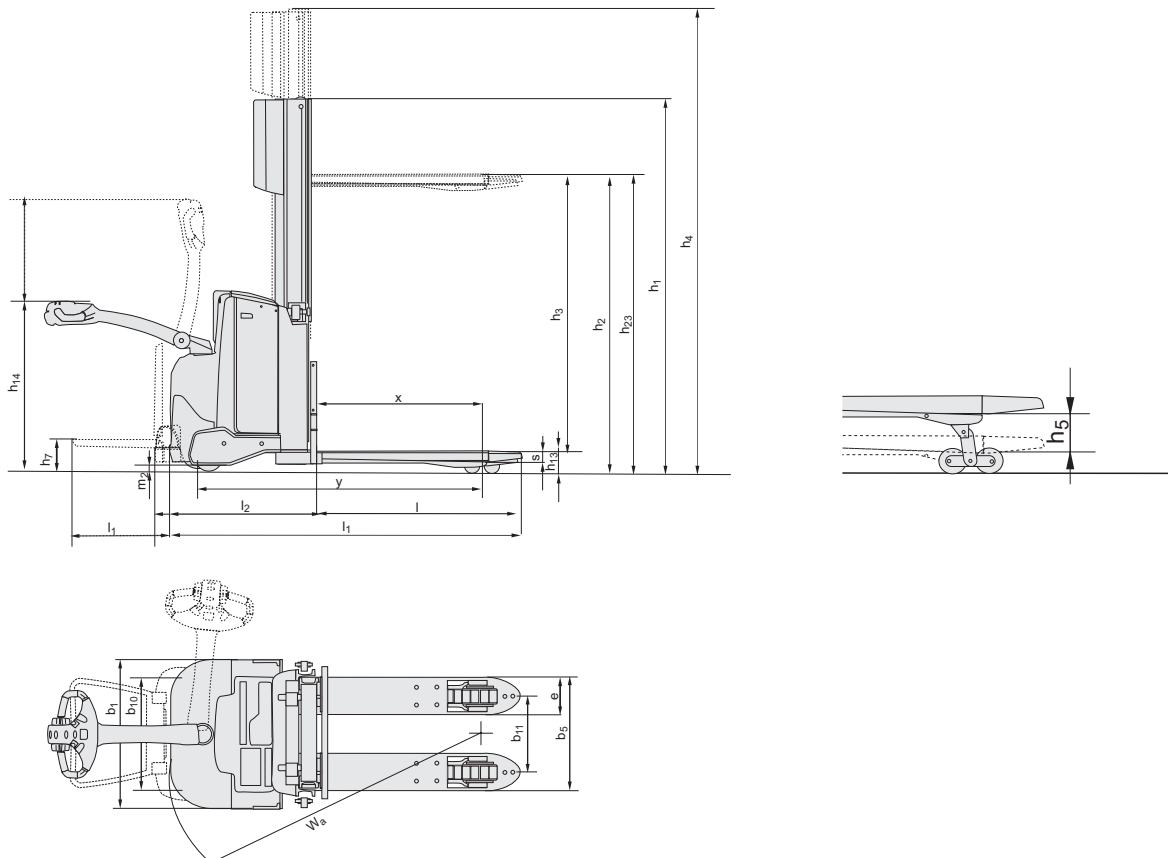

Truck features:

- BT Powerdrive System
- Fingertip controls
- Electronic braking system
- Electronic speed control
- Operator safety
- Storage compartments
- Automatic switch-off
- Click-2-creep
- Programmable performance
- Easy access for maintenance
- Built in charger (option)
- Sensilift (option)
- Flip-up operator platform (option)
- Toyota I_site: truck fleet management system (option)
- Hydraulic oil for low temperatures (option)



email: info@forstor.com.ua

site: www.forstor.com.ua